



FEBRUARY 2026

01 OVERNIGHT WEST TOWER INTERIOR LOBBY CLOSURES

From Friday, February 13 until Friday, February 20, the West Tower interior lobby will be closed between 8pm and 4am nightly for overhead construction work.

- Access between the West and East Towers will be available via the Plus 15 level by using the West Tower lobby scaffold stairs or parking shuttles.

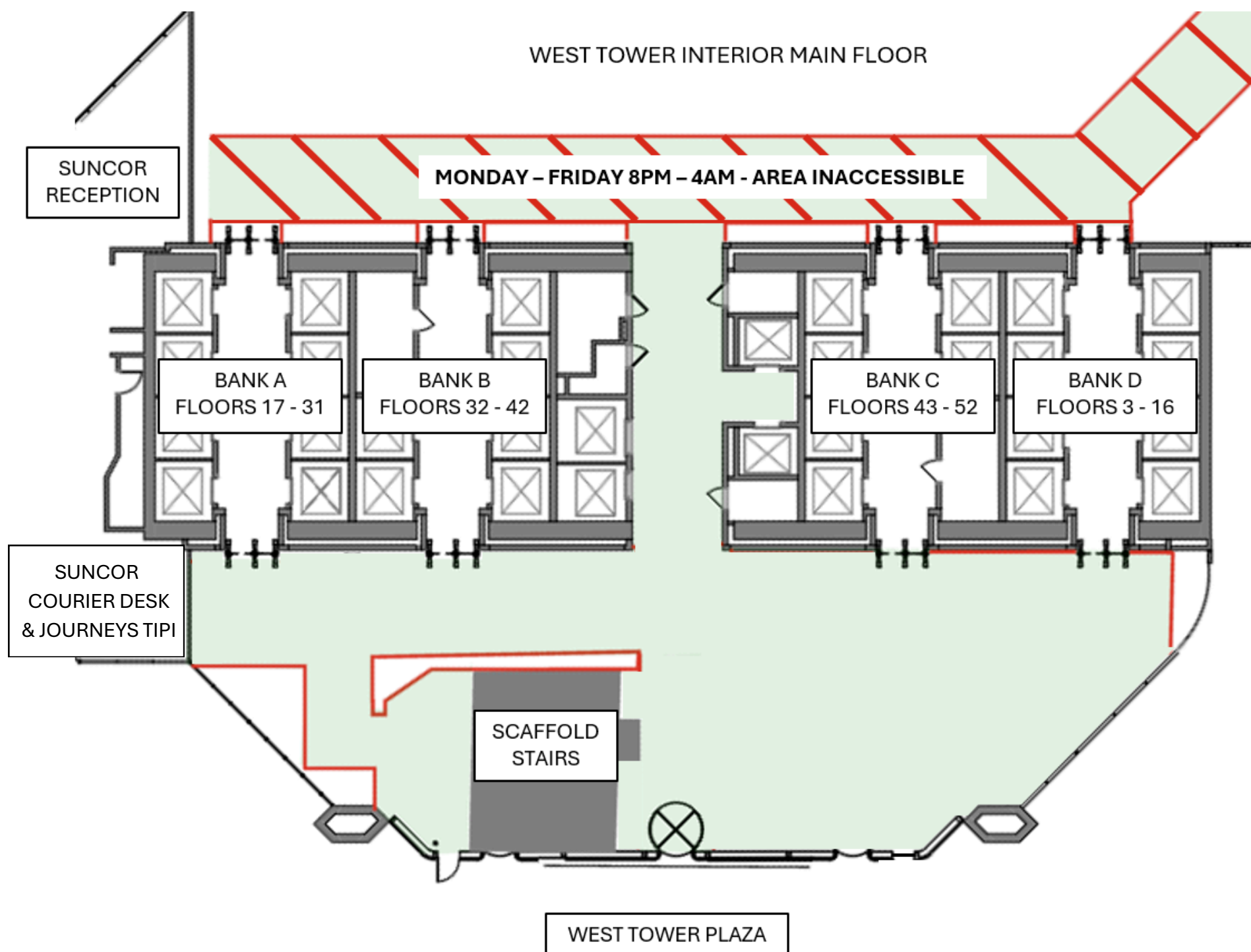

For your safety and the safety of others, please pay close attention to all redevelopment signage and tenant notices, and download the axiis app to receive regular updates.



FEBRUARY 2026

01 WEST TOWER MAIN ENTRANCE CLOSURE & TEMPORARY ENTRANCE OPENING

Beginning in March 2026, the West Tower main entrance will be closed for construction. A new temporary entrance next to the Suncor Courier Desk & Journeys Tipi will be created to maintain access prior to the closure. Access to passenger elevators, parking and freight shuttles, Suncor reception, Suncor Courier Desk, and the Journeys Tipi will be maintained.

- Starting February 18: construction of the new temporary entrance will begin.
- Starting March 2: West Tower main entrance will be closed for construction.
- Late 2026: West Tower main entrance scheduled to re-open.

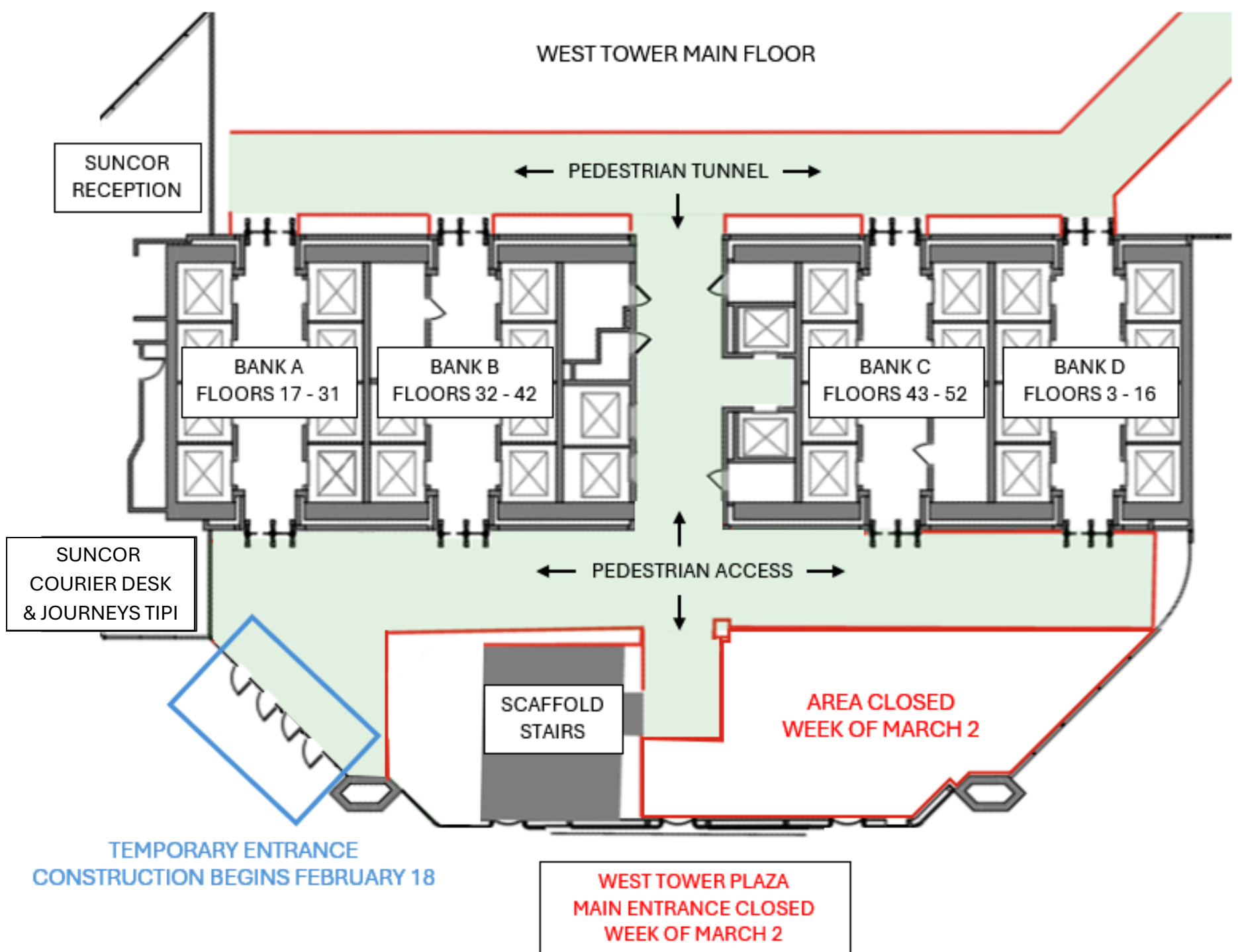

For your safety and the safety of others, please pay close attention to all redevelopment signage and tenant notices, and download the axiis app to receive regular updates.